

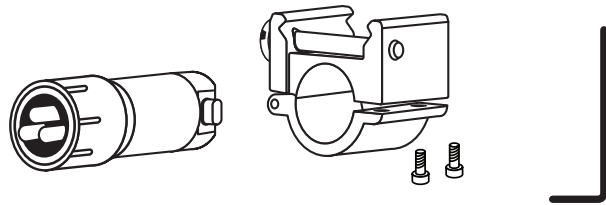

## Sub Compact Flashlyte System

WL-1



### Installation

- 1 Unscrew switch and slide into mount.
- 2 Screw the switch back into the flashlyte.
- 3 Insert Screws into mount and tighten.
- 4 A. Loosen the clamp screw/cross bar.  
B. Align clamp screw/cross bar with cross cut on rail.  
C. Press the flashlyte onto the rail.
- 5 Tighten the clamp screw/cross bar until snug.

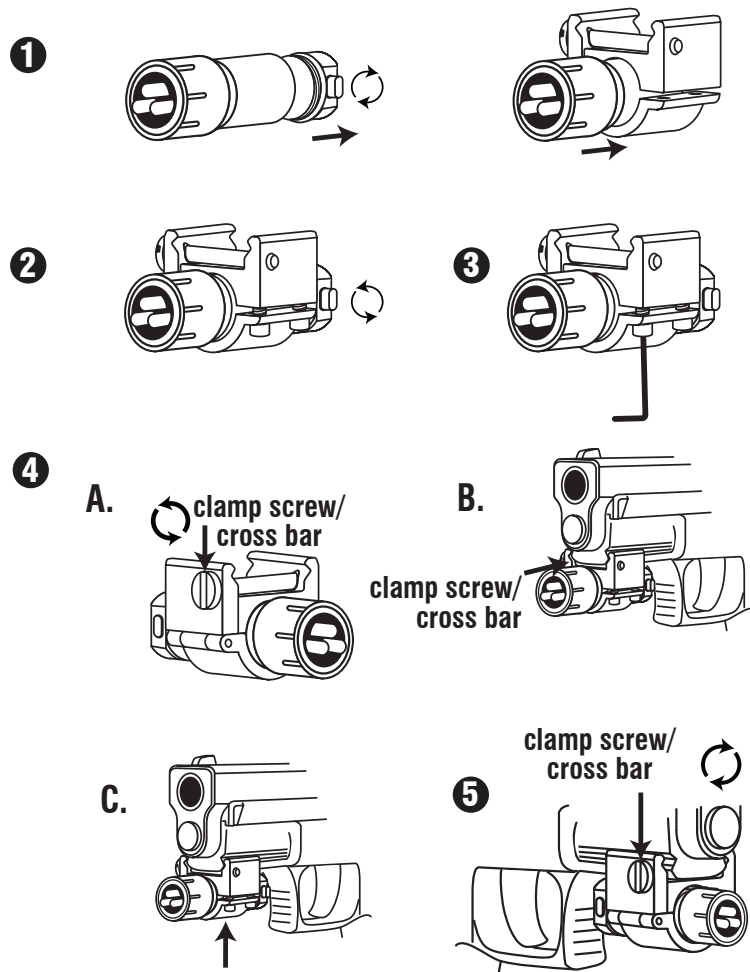

### Activation

- 1 To turn "On" the laser, press either side of the switch in until it clicks.  
To turn "Off" press the switch back to the centered position.

#### 1 Back View of Switch

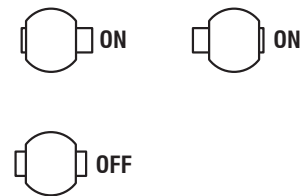

### Battery Replacement

- 1 Unscrew slide switch and remove old batteries.
- 2 Insert 4 - A76 batteries with positive facing slide switch. Screw switch back into flashlyte.

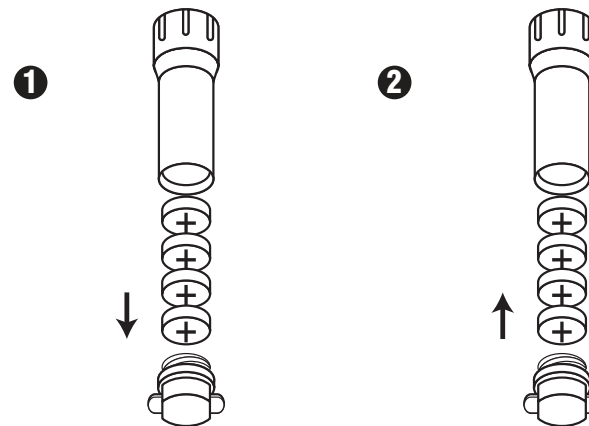

**WARRANTY:**  
**One Year Limited**  
**Warranty.**



A Division of P&L Industries  
 101 Airpark Road - Cottonwood, AZ 86326  
 Phone 928-649-3201 - Fax 928-649-3970  
[www.LaserLyte.com](http://www.LaserLyte.com)